

0' 5'

**BASEMENT**

FLOOR PLAN AREA 1,758 sq.ft.

APPROXIMATE SQUARE FOOTAGE  
ALL DRAWINGS ARE FOR ILLUSTRATIVE PURPOSES ONLY

3020 STONEY CREEK DRIVE, BRIGHTS GROVE, ON

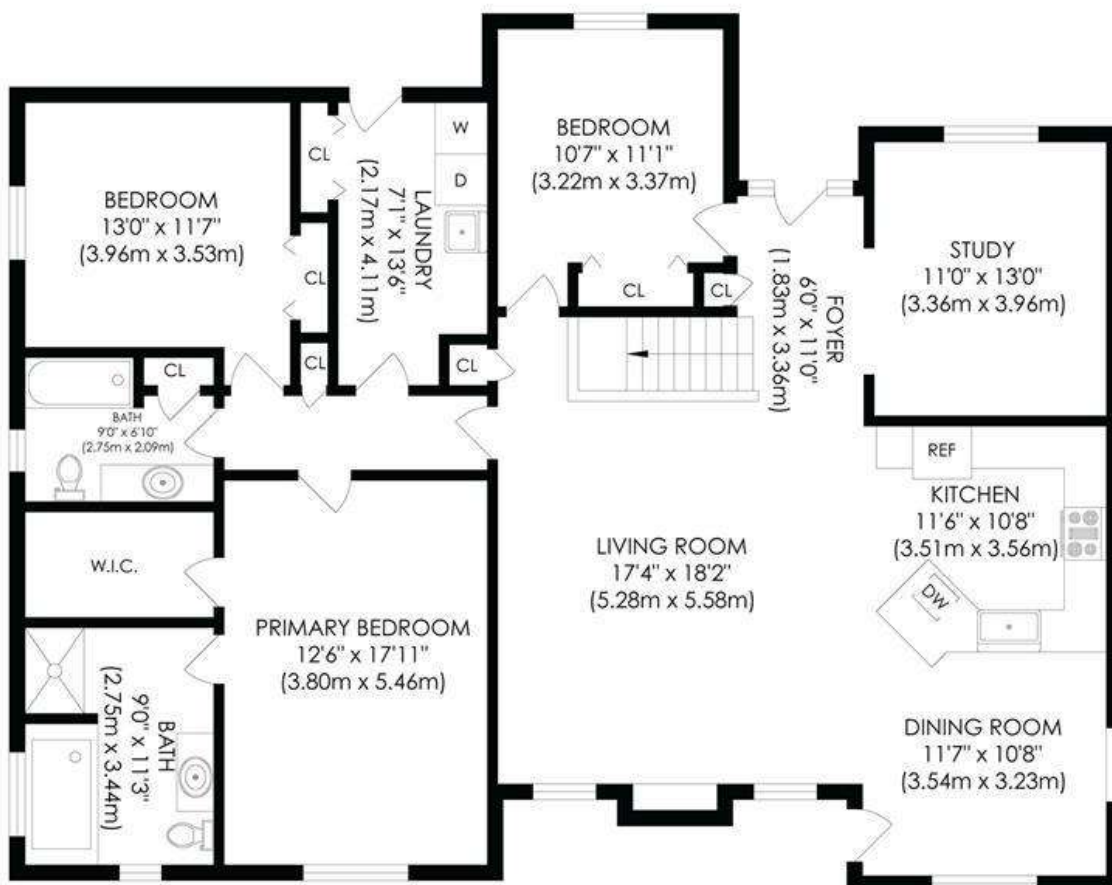

MAIN LEVEL

FLOOR PLAN AREA 1,787 sq. ft.

APPROXIMATE SQUARE FOOTAGE  
ALL DRAWINGS ARE FOR ILLUSTRATIVE PURPOSES ONLY

3020 STONEY CREEK DRIVE, BRIGHTS GROVE, ON

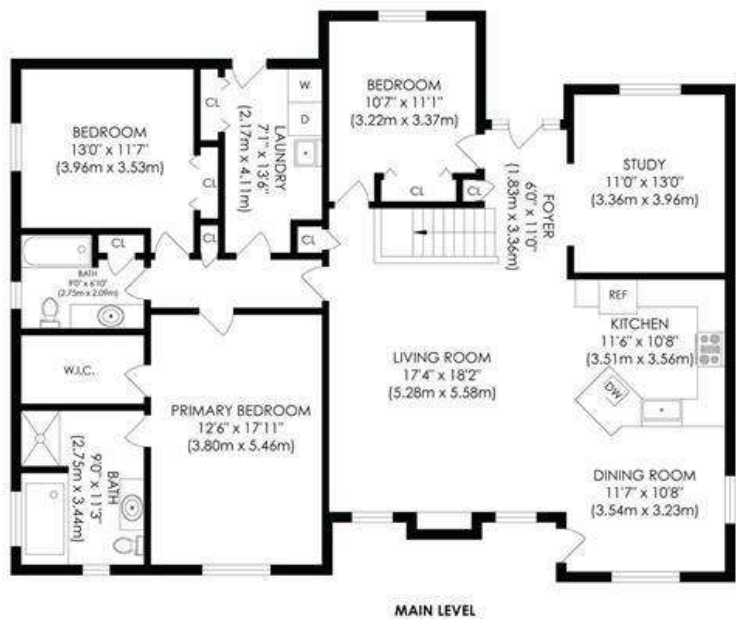
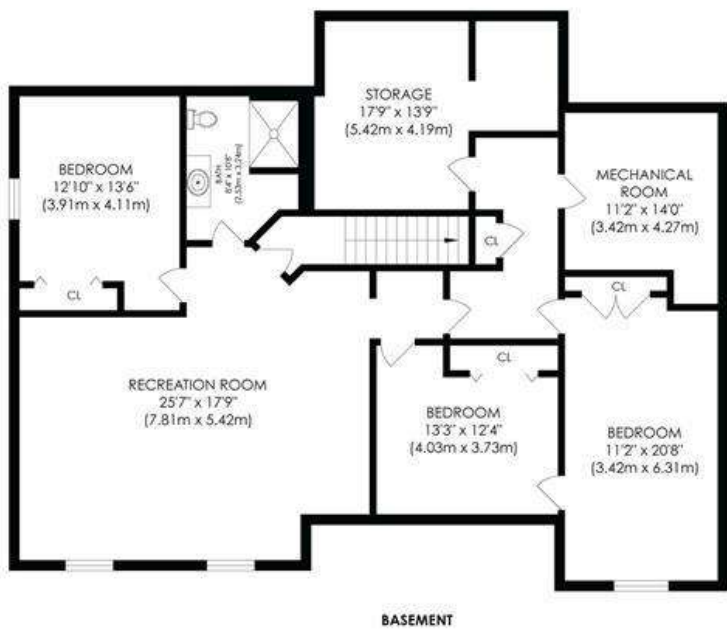

FLOOR PLAN AREA 3,545 sq.ft.

APPROXIMATE SQUARE FOOTAGE  
ALL DRAWINGS ARE FOR ILLUSTRATIVE PURPOSES ONLY

3020 STONEY CREEK DRIVE, BRIGHTS GROVE, ON